

NOTE

WI = 1/2" Threaded SS Pipe
 Waste = PVC Pipe DWV 40mm
 EC = Electrical Connection: 12kW, 3N 415V, 50Hz, 18.5A

UNLESS OTHERWISE SPECIFIED:
 1. DIMENSIONS ARE IN MILLIMETRES
 2. TOLERANCES:
 LINEAR: +/- 1mm
 ANGULAR: +/- 0.30°
 3. BEND RADIUS 2mm. ALL BENDS AT 90°

SURFACE FINISH:
 1. NATURAL (LEAVE FILM INTACT FOR DELIVERY).
 2. NO BLEMISHES OR SCRATCHES ON BASE METAL.
 3. REMOVE ALL BURRS AND SHARP EDGES.

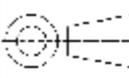

DO NOT SCALE DRAWING REVISION: -

B+S
B & S Commercial Kitchens
 57 Plateau Road, Reservoir Victoria, 3073
 Tel.: (03) 9469 4754 / Fax: 9469 4504

NAME	SIGNATURE	DATE	THICKNESS (mm)
DRAWN S.K		20/05/2024	-
CHK'D			
APPV'D			MATERIAL:
MFG			
Q.A			
			WEIGHT:

TITLE:	IN-W2-12
DWG NO.	
SCALE: 1:10	SHEET 1 OF 1
	A3