

NOTE

WI = 1/2" Threaded SS Pipe
 Waste = PVC Pipe DWV 40mm
 EC = Electrical Connection: 8kW, 3N 415V, 50Hz, 12.5A

UNLESS OTHERWISE SPECIFIED:
 1. DIMENSIONS ARE IN MILLIMETRES
 2. TOLERANCES:
 LINEAR: +/- 1mm
 ANGULAR: +/- 0.30°
 3. BEND RADIUS 2mm. ALL BENDS AT 90°

SURFACE FINISH:
 1. NATURAL (LEAVE FILM INTACT FOR DELIVERY).
 2. NO BLEMISHES OR SCRATCHES ON BASE METAL.
 3. REMOVE ALL BURRS AND SHARP EDGES.

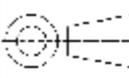

DO NOT SCALE DRAWING REVISION: -

B & S Commercial Kitchens
 57 Plateau Road, Reservoir Victoria, 3073
 Tel.: (03) 9469 4754 / Fax: 9469 4504

NAME	SIGNATURE	DATE	THICKNESS (mm)	MATERIAL	WEIGHT
DRAWN	S.K	20/05/2024	-		
CHK'D					
APPV'D					
MFG					
Q.A					

TITLE:		IN-W1-8	
DWG NO.		A3	
SCALE: 1:10		SHEET 1 OF 1	