

Project: _____ Item: _____



DLZS2N-C4D6

Standard Features:

- AISI grade stainless steel
- Heavy duty complete stainless steel cabinet frame
- 2.6kW and 2kW solid plate cook zones
- One-piece machine pressed top surface - 2mm Thick
- Seamless cast iron hot plates - 190mm Dia and 230mm Dia
- Rotary control knob with three power settings
- Red and green operation indicators
- Internal cooling fans conserve working temperatures of all electronics
- Front access to all components makes service easy

Options:

- SCCP - Colored Control Panel
- SCCS - Non-swivel rear castors - Set of two
- SCPK - Plinth Kit

Specifications:

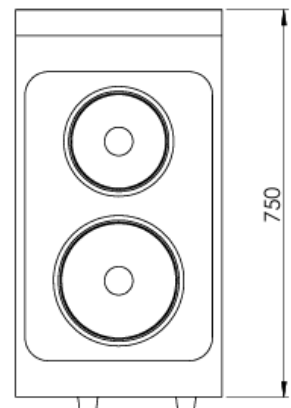
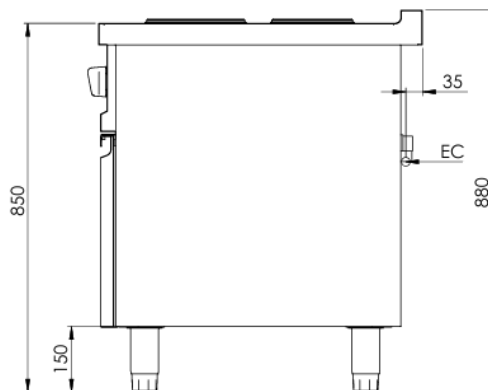
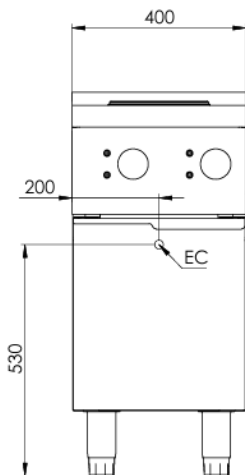

MODEL	LENGTH (mm)	DEPTH (mm)	HEIGHT (mm)	NET WEIGHT (kg)
DLZS2N-C4D6	400	750	880	30

Connections:

ELECTRICAL CONNECTION (EC)	ELECTRICAL SUPPLY REQUIREMENTS				
	VOLTAGE (V)	TYPE	FREQUENCY (Hz)	POWER (kW)	L1, L2, L3 AMPS (A)
Hard Wired	415	3P+E	50/60	2.6 + 2	12

- **Must** be installed by an authorised installer in accordance to **AS/NZS 3000** refer to current publications

Due to ongoing Product Development, Product Improvement and Research, B+S Commercial Kitchens reserves the right to alter specifications and the design of the product without notice.

Electromagnetic Compatibility: AS/NZS CISPR 14.1