



K+ SERIES: KBT-SB2 Two Burner Boiling Top on Stand

Project: _____ Item: _____



KBT-SB2

Standard Features:

- AISI grade stainless steel
- Heavy duty complete stainless steel frame with undershelf
- 30MJ removable two-piece open cooktop burner
- Heavy duty cast iron boiling top trivets
- Flame failure device included as standard
- Multi-setting gas valve allows greater regulation of flame settings
- Easy access to all components for servicing and adjustments
- Easy to clean fat spillage tray and rear splashback heat deflector

Options:

- NG/LPG - Available in Natural or LP Gas
- PLT - Pilot light - per burner
- SPB - Spillage Bowl
- BM - Bench mounted
- CS - Non-swivel rear castors - Set of two

Specifications:

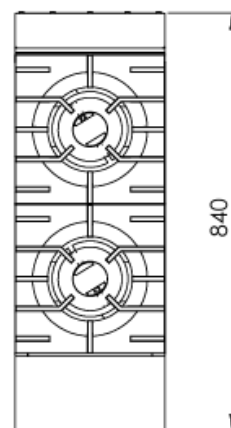
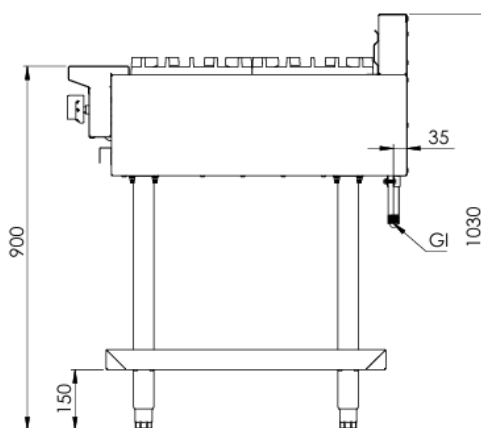
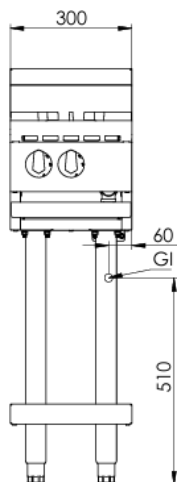

| MODEL | LENGTH (mm) | DEPTH (mm) | HEIGHT (mm) | NET WEIGHT (kg) | GAS CONSUMPTION (MJ/h) | |
|---------|----------------|---------------|----------------|--------------------|------------------------|-----|
| | | | | | NG | LPG |
| KBT-SB2 | 300 | 840 | 1030 | 50 | 60 | 50 |

Connections:

| GAS (GI) (BSP) | SUPPLY PRESSURE (kPa) | |
|-------------------|-----------------------|-----|
| | NG | LPG |
| 3/4" (M) | 1.0 | 2.6 |

- Gas regulator is supplied with the unit
- The unit must be installed by an authorised installer in accordance to **AS/NZS5601 refer to current version**

Due to ongoing Product Development, Product Improvement and Research, B+S Commercial Kitchens reserves the right to alter specifications and the design of the product without notice.

Approval Number: GMK 10703



B+S Commercial Kitchens
57 Plateau Road Reservoir VIC 3073 Australia | +61 3 9469 4754
info@bscommercialkitchens.com | www.bscommercialkitchens.com

